

SUSPENSION PARTS (Radius Rods, Torque Rods & Parts)
Neway Torque Rod Bush Assembly

TORQUE ROD BUSH ASSEMBLY – STRADDLE MOUNT

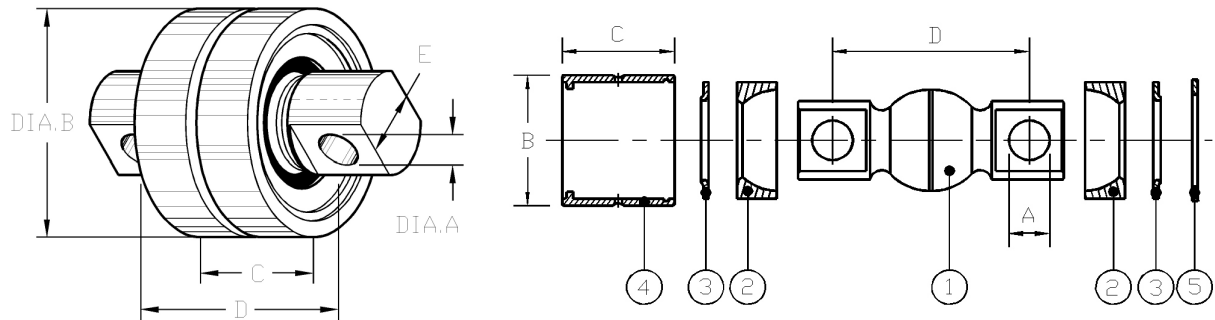

PART NO.	INCLUDES	A SHAFT HOLE DIA.	B BOSS O.D.	C BOSS WIDTH	D SHAFT HOLE TO HOLE	E SHAFT ACROSS S FLATS	APPLICATION AND GENERAL INFORMATION
09.1517.08	1. 09.1517.03 Shaft (1) 2. 09.1505.09 Bush-Red (2) (Heavy Duty Bush) 3. 09.1517.06 Washer (2) 4. 09.1517.05 Boss Outer (1) 5. 38.130.680 Circlip (1)	19.8	88.8	68.0	111.1	36.3	For Mack, Neway AD. 252-11 and Rockwell Suspensions Replaces: Mack 380F29407M
09.1520.08	1. 09.1520.03 Shaft (1) 2. 09.1521.09 Bush-Red (2) (Heavy Duty Bush) 3. 09.1521.06 Washer (2) 4. 09.1521.05 Boss Outer (1) 5. 38.130.090 Circlip (1)	26.0	104.7	63.5	135.7	34.9	For Mack, Neway AD. 252-11, Rockwell (Large O.O. Boss - Large Shaft) and Western Star Replaces: Mack 380F29402M Rockwell A-2297-D-82A Rockwell A-2297-X-3664

SUSPENSION PARTS (Radius Rods, Torque Rods & Parts)
Neway Torque Rod Bush Assembly

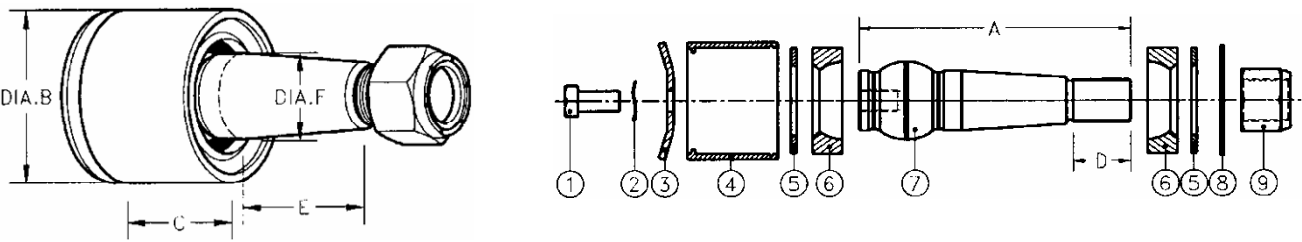
								
PART NO.	INCLUDES	A SHAFT OVER ALL LENGTH	B BOSS O.D.	C BOSS WIDTH	D SHAFT THREA D	E SHAFT TAPER LENGTH	F SHAFT TAPER DIA.	APPLICATION AND GENERAL INFORMATION
09.1517.28	1. 71.058.10.125 Bolt(1) 2. 70.111.10 Washer (1) 3. 09.1520.26 Washer (1) 4. 09.1517.05 Boss Outer (1) 5. 09.1517.26 Washer (2) 6. 09.1505.09 Bush-Red (2) 7. 09.1517.23 Shaft (1) 8. 38.130.085 Circlip (1) 9. 71.611.20 Nyloc Nut(1)	203.5	88.8	68.0	1-1/4" 12 TPI UNF	78.4	45.0	For Mack, Neway AD. 252-11 and Rockwell Suspensions Replaces: Mack 38QF29408M
09.1520.28	1. 71.058.10.125 Bolt(1) 2. 70.111.10 Washer (1) 3. 09.1520.26 Washer (1) 4. 09.1521.05 Boss Outer (1) 5. 09.1521.06 Washer (2) 6. 09.1521.09 Bush-Red (2) 7. 09.1520.23 Shaft (1) 8. 38.130.085 Circlip (1) 9. 71.611.20 Nyloc Nut(1)	200.0	104.7	63.5	1-1/4" 12 TPI UNF	73.8	35.3	For Mack and Neway AD. 252-11 Suspensions Replaces: Mack 38QF29403M

